



HYUNDAI SONATA

INSTALLATION GUIDE

DN8 Series (V1-V4)

Unboxing



Before starting, Familiarise yourself with this process and ensure that you have the skills and capabilities to perform this install with all safety measures in place. When you're ready, remove the factory system from the vehicle prior to installing your new catback. It's best to unpackage all the contents of your system and lay it out on the floor as shown below, to ensure everything is present and so that you can familiarise yourself with the individual components throughout the install.

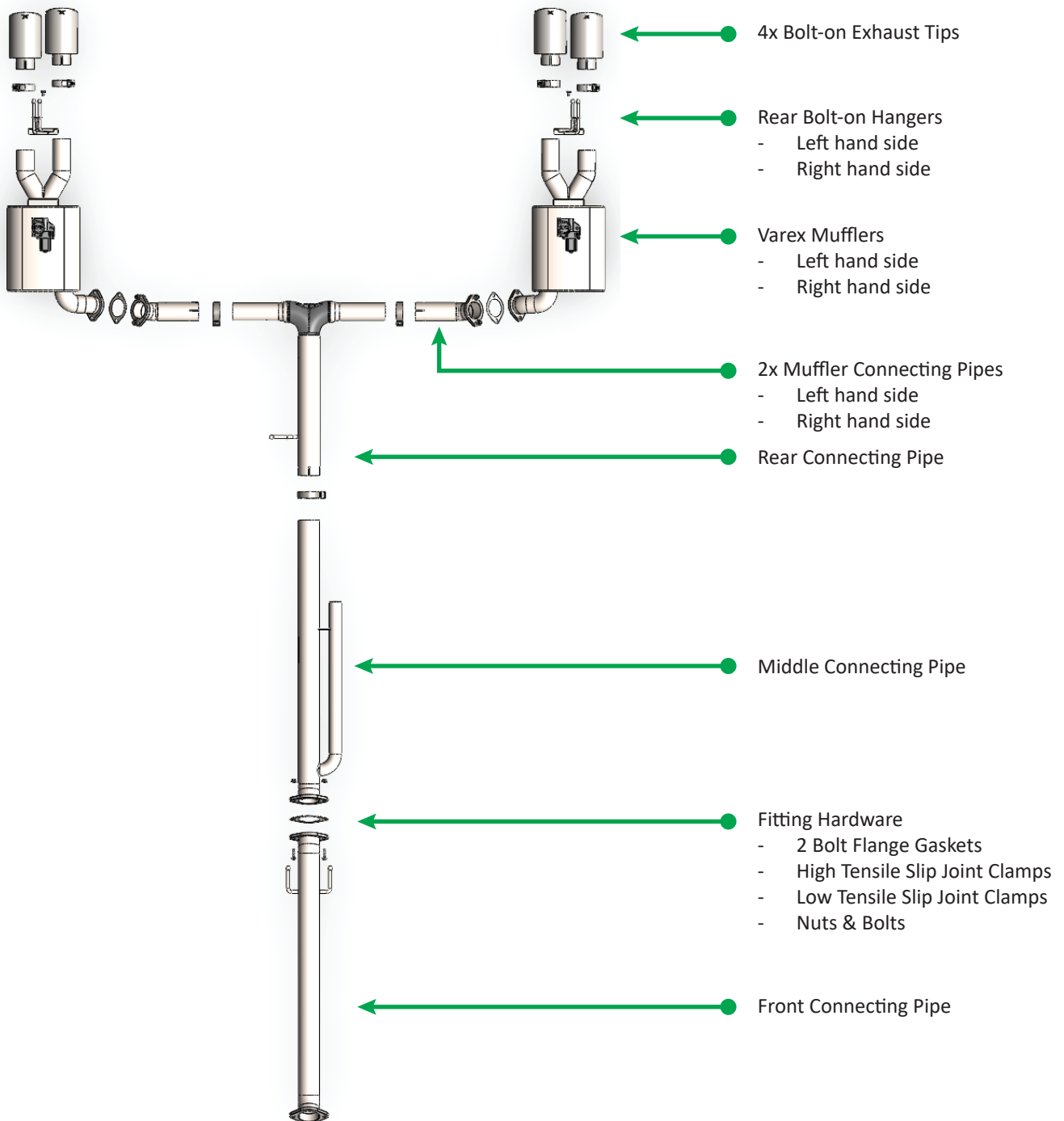

XFORCE RECOMMENDS AN AUTHORISED PROFESSIONAL TO INSTALL ALL PRODUCTS

WARNING: When working on any vehicle exercise extreme caution. Please allow the vehicles exhaust system to be cool enough to touch before removal. Failing to do so may result in severe burns. If working without a hoist refer to the vehicles manual to check correct lifting specifications. Always wear safety glasses, protective gloves and ensure your working in a safe area. Serious injury or death can occur if the correct safety measures are not followed.

ATTENTION: Please read the instructions carefully. XForce will only warrant manufacturing faults. This does not extend to damage or breakage due to incorrect fitment.



Fitting Instructions:

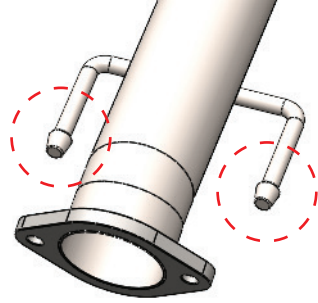

1 Attach the front connecting pipe to the two rubber hangers on the chassis in the middle of the car. Once the rear of the pipe is supported, slide its flange onto the stud of the downpipe, making sure the original gasket stays in place between them. Then secure it using the original factory nuts.

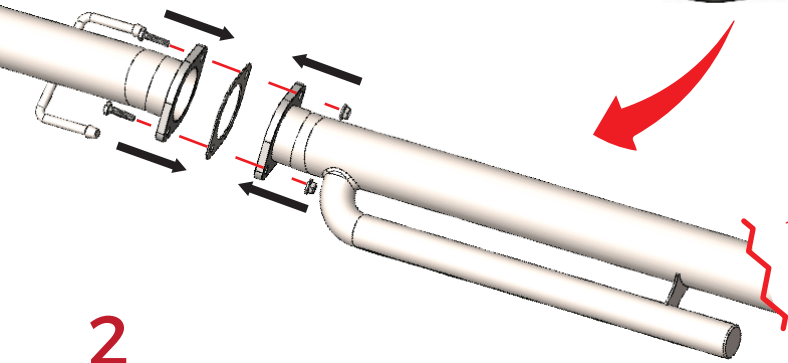

2 Line up the flange on the middle connecting pipe with the flange on the front pipe, place the supplied gasket between them, and secure everything with the provided nuts and bolts. The pipe will hang down at this point, so it helps to have someone support it while you continue.

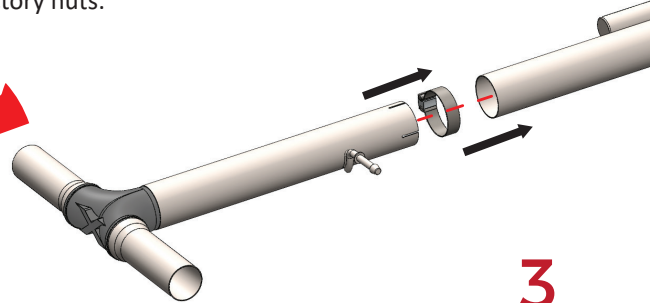

3 Slide the rear connecting pipe over the end of the middle pipe, making sure the slip-joint clamp is already on the pipe first. Insert the hanger into the rubber mount on the chassis, then lightly tighten the clamp so it holds the pipe but can still be adjusted.

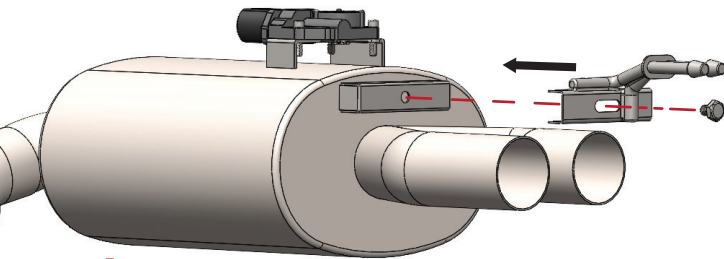

4 Attach the hanger brackets to the left and right mufflers and loosely secure them to the muffler brackets using the supplied short bolts.

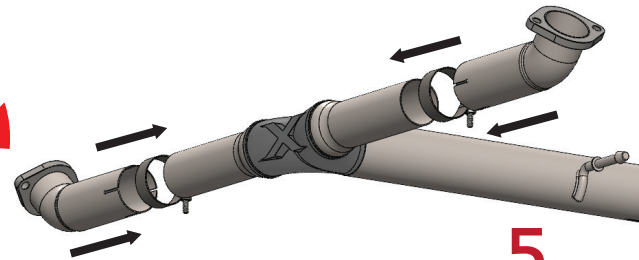

5 Fit the adapter pipes to both mufflers using the supplied gaskets, nuts, and bolts, and tighten them lightly so they can still be adjusted. Hang the mufflers in the rear rubber mounts, then slide each muffler connecting pipe over the rear connecting pipe on its side.

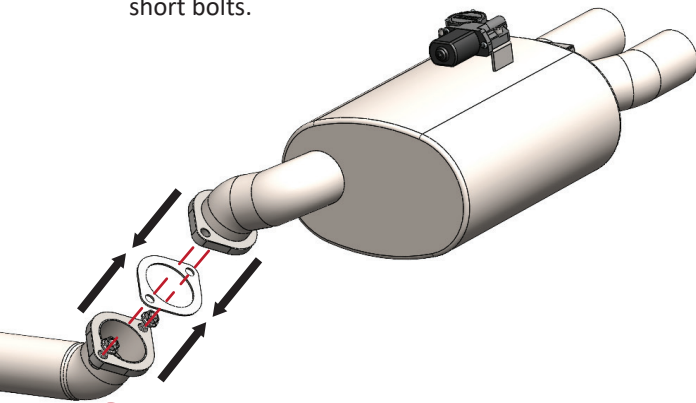

6 Bolt the muffler to the adapter pipe using the supplied nuts and bolts, making sure the two-bolt gasket sits properly between the flanges. Once both sides are loosely connected, level the whole system and then tighten everything to secure it in place.

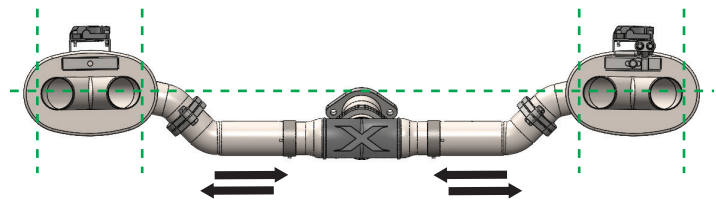

7 Slide each tip onto the tailpipe and align the top edge so it sits flush with the furthest point of the diffuser to prevent heat damage. Use the "X" logo to centre and straighten the tip, then secure it with the supplied low-tensile slip-joint clamp. Repeat this for the remaining three tips.

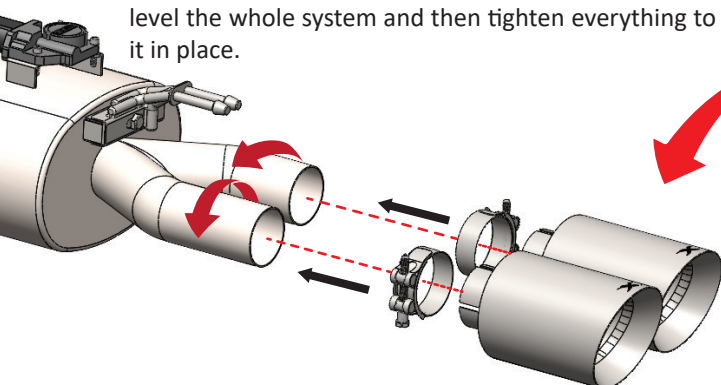

Once finished, start the car, let the exhaust heat cycle, check for any leaks, and re-tighten any connections if needed.



